

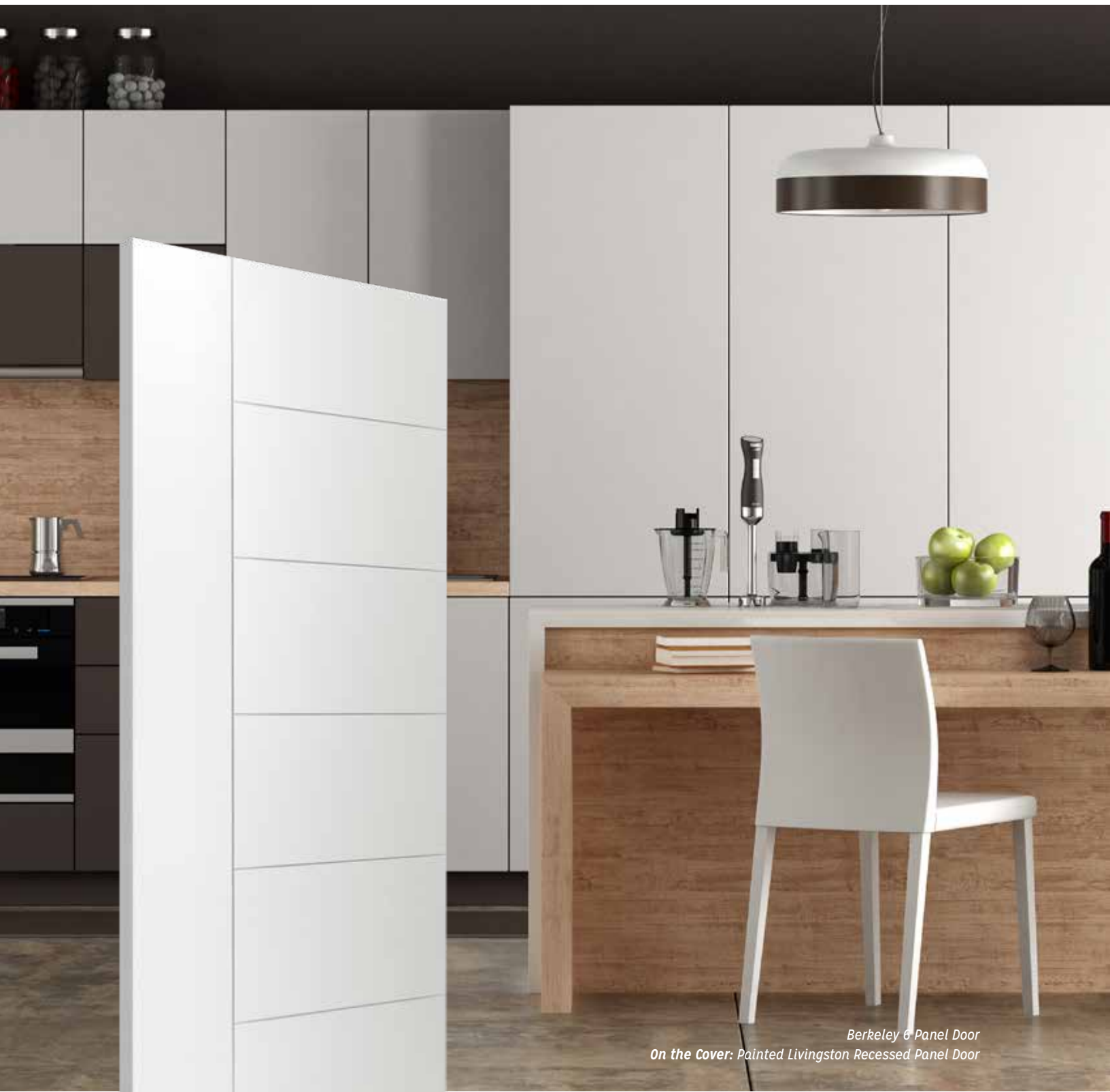

INTERIOR DOORS
2020



*Berkeley 6 Panel Door
On the Cover: Painted Livingston Recessed Panel Door*



INTERIOR DOORS

2020

Madero's interior door collections feature the latest designs and timeless classics, providing a range of style, material, and budget options to suit your specific needs. From renovations to new home construction, these doors will provide exceptional value and style for your home.

Interior doors are readily available in 6'8", 7'0", 8'0", or custom door slab heights, and standard widths. Hardware, frame and mounting options are available to ensure that your interior doors will complement the decor in every room.

Contents

- Moulded Panel..... 6-17**
 - Recessed Panel 8-9
 - Heritage Series 10-11
 - West End Collection..... 12-13
 - Classics™ 14-15
 - Select™ 16-17
- Flush Panel..... 18-21**
- Stile & Rail..... 22-25**
 - Mix & Match French Doors 22
 - One Lite French Doors..... 23
 - Panel Lite French Doors..... 23
 - Primed Engineered Wood 24
 - Wood Panel 25
- Hinge Options..... 26**
- Wood Frame Options 27**
- Barn Track Hardware 28**
- Fire Rated Frame Options 30**
- Checklist for Ordering..... 31**



Painted 3-Panel Winslow Panel Door



MADERO. DOORS FOR LIFE.

Modern, contemporary, colonial, or eclectic, Madero has a deep respect for the subtleties of timeless design, but it doesn't end there. Partnering with innovative manufacturers and offering industry-leading warranties, Madero's selection of doors stand the test of time.

Take a look, and see what you find. For more, visit us online at www.madero.ca.

MOULDED PANEL

Madero is proud to partner with Masonite® to provide moulded panel doors that have been transforming interiors for over 80 years. Together we are relentlessly committed to delivering product, service and design innovations which will enhance the beauty and functionality of your home.

Quality Is Our Standard

Moulded panel doors from Masonite are more durable and resist warping, shrinking and cracking. These beautifully engineered doors are available in a smooth or textured woodgrain finish, with matching bifolds to suit any decor. They come in a wide range of widths and heights and are primed for easy finishing. By-product wood chips and timber from sustainably managed forests are used at Masonite facilities, with a commitment to environmental excellence in every step of the door manufacturing process.



MASONITE.



Painted Riverside 6-Panel Equal (8/0) Door with Schlage Accent Lever in Satin Nickel



Hollow Core

- Perfect solution for budget-minded customers.
- 1-3/8" or 1-3/4" thickness available; primed white and ready to paint.
- Contains pre-consumer recycled content, resource efficient materials and a honeycomb core.



hollow core

Safe 'N Sound® Solid Core

- For reduced sound transmission; ideal for bathrooms and bedrooms where privacy and safety are a concern.
- 1-3/8" and 1-3/4" thickness available in most moulded panel designs and sizes.
- 20 minute fire rating available in 1-3/4" thickness only.
- Offers heft and feel of solid wood; primed white and ready to paint.
- Manufactured with DorCor™, a low density fiberboard made from wheat straw (annually renewable, agricultural, wheat by-product).



safe:sound
SOLID CORE MOULDED PANEL DOORS

Safe 'N Sound® Emerald™ Solid Core

- Ideal product for allergen-sensitive customers requiring optimal air quality.
- 1-3/8" and 1-3/4" thickness available in most moulded panel designs and sizes.
- 20 minute fire rating available in 1-3/4" thickness only.
- Offers heft and feel of solid wood; primed white and ready to paint.
- Forest Stewardship Council (FSC) certified wood, containing environmentally preferred products: low emissions adhesives and sealants, extremely low VOC emissions, and no added urea-formaldehyde (NAUF).



safe:sound
EMERALD™ SOLID CORE MOULDED PANEL DOORS



Livingston Recessed Panel Door

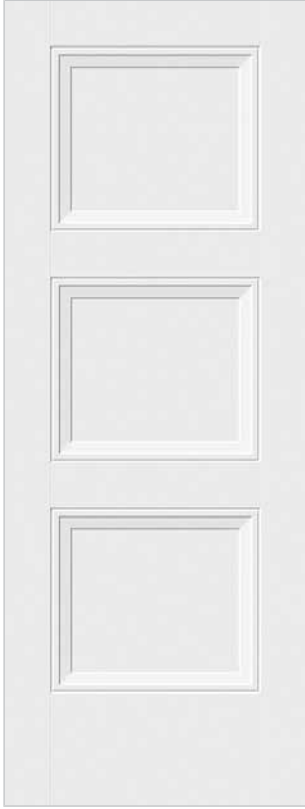

Livingston
LIV
3-Panel Equal



RECESSED PANEL SERIES

Livingston Recessed Panel Slab

- Door** Paintable recessed panel; smooth primed surface
- Core** Hollow core 1-3/8" or solid core (refer to page 7); solid core recommended for bedrooms and bathrooms
- Thickness** 1-3/8" or 1-3/4"; bifold 1-3/8" only
- Height** 80" (6/8), 84" (7/0), 96" (8/0)
- Passage** 18" (1/6), 24" (2/0), 28" (2/4), 30" (2/6), 32" (2/8), 34" (2/10), 36" (3/0)
- Bifold** 24" (2/0), 30" (2/6), 36" (3/0)
- Fire Rated** 20 minute (1-3/4" only)
- Optional** Safe 'N Sound® Solid Core, Emerald Series
- Warranty** 1 year limited





Painted Lincoln Park 1-Panel Equal Door

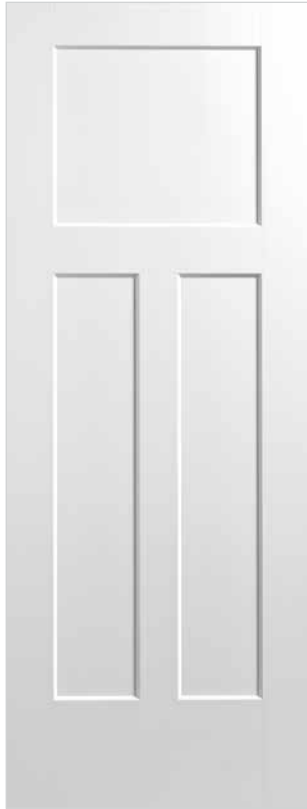

Winslow 3-Panel



HERITAGE SERIES

Moulded Shaker Panel Slab

- Door** Paintable moulded panel; smooth primed surface
- Core** Hollow core 1-3/8" or solid core (refer to page 7); solid core recommended for bedrooms and bathrooms
- Thickness** 1-3/8" or 1-3/4"; bifold 1-3/8" only
- Height** 80" (6/8), 84" (7/0), 96" (8/0)
- Passage** 18" (1/6), 24" (2/0), 28" (2/4), 30" (2/6), 32" (2/8), 34" (2/10), 36" (3/0)
- Bifold** 24" (2/0), 30" (2/6), 36" (3/0)
- Fire Rated** 20 minute (1-3/4" only)
- Optional** Safe 'N Sound® Solid Core, Emerald Series
- Warranty** 1 year limited

Masonite's Heritage® Series features stile and rail inspired designs with clean, simple lines that will provide a distinctive look for any interior decor. For increased privacy and sound reduction, choose the solid core option.



Shaker Style Detail



Lincoln Park
LINC
1-Panel Equal



Winslow
WINS
3-Panel: 1 Square Panel
with 2 Vertical Panels
(Not available in 96" height)



Logan
LOGAN
2-Panel



Painted Berkley 6-Panel Equal with 1 Vertical Panel

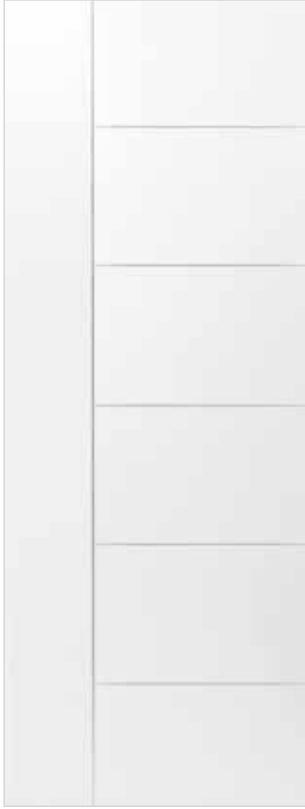

Berkley 6-Panel Equal with 1 Vertical Panel



WEST END COLLECTION

Moulded Grooved Panel Slab

- Door** Paintable moulded panel; smooth primed surface
- Core** Hollow core or solid core (refer to page 7); solid core recommended for bedrooms and bathrooms
- Thickness** 1-3/8" or 1-3/4"; bifold 1-3/8" only
- Height** 80" (6/8), 84" (7/0)
- Passage** 18" (1/6), 24" (2/0), 28" (2/4), 30" (2/6), 32" (2/8), 34" (2/10), 36" (3/0)
- Bifold** 24" (2/0), 30" (2/6), 36" (3/0)
- Fire Rated** 20 minute (1-3/4" only)
- Optional** Safe 'N Sound® Solid Core, Emerald Series
- Warranty** 1 year limited

Masonite's West End™ Collection features metropolitan inspired designs with bold, graphic lines for eye-catching profiles. These clean, simple styles will complement any contemporary interior decor. For increased privacy and sound reduction, choose the solid core option. West End doors are very affordable, giving you the most value for a modern look.

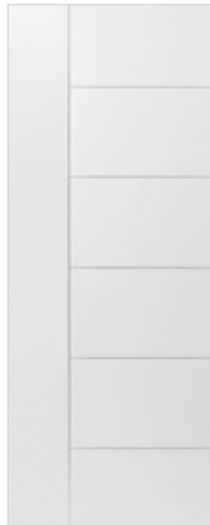

Berkley
BER
6-Panel Equal with 1 Vertical Panel

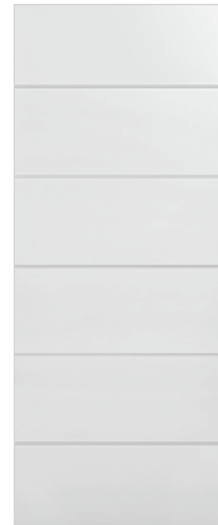

Melrose
MEL
6-Panel Equal
(Not recommended for double doors)



*Painted Carrara 2-Panel Smooth Door with
Schlage Latitude Lever in Satin Chrome*



Roman



CLASSIC MOULDED PANEL

Classic Moulded Raised Panel Slab

Door	Paintable moulded panel; textured woodgrain or smooth primed surface
Core	Hollow core or solid core (refer to page 7); solid core recommended for bedrooms and bathrooms
Thickness	1-3/8" or 1-3/4"; bifold 1-3/8" only
Height	80" (6/8), 84" (7/0), 96" (8/0)
Passage	18" (1/6), 24" (2/0), 28" (2/4), 30" (2/6), 32" (2/8), 34" (2/10), 36" (3/0)
Bifold	24" (2/0), 30" (2/6), 36" (3/0)
Fire Rated	20 minute (1-3/4" only)
Optional	Safe 'N Sound® Solid Core, Emerald Series
Warranty	1 year limited

The Masonite Classics™ Moulded Panel Series is the industry benchmark for all moulded wood doors and features five popular door designs.



Carrara
CARR - 2PSM
Smooth only



Classique
CLASS - 2ARTX
Textured: 80" only



Colonist
COL - 6PTX/SM
Smooth or Textured



Coventry
COV - 4PSM
Smooth only



Roman
ROM - 2ROMNSM
Smooth only;
(96" height not available in bifold)



Painted Cheyenne 2-Panel Camber Top Plank



Riverside 6-Panel Equal (8/0)



SELECT MOULDED PANEL

Select Moulded Panel Slab

Door	Paintable moulded panel; smooth primed surface
Core	Hollow core or solid core (refer to page 7); solid core recommended for bedrooms and bathrooms
Thickness	1-3/8" or 1-3/4"; bifold 1-3/8" only
Height	80" (6/8), 84" (7/0), 96" (8/0)
Passage	18" (1/6), 24" (2/0), 28" (2/4), 30" (2/6), 32" (2/8), 34" (2/10), 36" (3/0)
Bifold	24" (2/0), 30" (2/6), 36" (3/0)
Fire Rated	20 minute (1-3/4" only)
Optional	Safe 'N Sound® Solid Core, Emerald Series
Warranty	1 year limited

The SELECT™ Collection is a special edition of the Moulded Panel Series, honouring more than 80 years of Masonite's heritage of innovation. These classic designs with a smooth, primed surface offer the ultimate in wood door authenticity.



Cheyenne
CHEY

2-Panel Camber Top Plank;
80" or 96" height only



Riverside
RIV

5-Panel Equal (80", 84");
6-Panel Equal (96")

FLUSH PANEL



Uniform Light Birch Flush Panel Door

Flush panel doors provide a modern architectural look with natural beauty for smaller budget renovations. Choose from hardboard, natural wood veneer or prefinished panels.

Slab

- Door** Hardboard or wood veneer with high-quality wood conditioner; or factory prefinished with high-quality topcoat
- Core** Hollow core or solid core (refer to page 7); solid core recommended for bedrooms and bathrooms
- Thickness** 1-3/8" or 1-3/4"
- Height** 80" (6/8), 84" (7/0), 96" (8/0)
- Passage** 18" (1/6), 24" (2/0), 28" (2/4), 30" (2/6), 32" (2/8), 34" (2/10), 36" (3/0), 42" (3/6), 48" (4/0)
- Bifold** 24" (2/0), 30" (2/6), 36" (3/0)
- Fire Rating** 20, 45, 60, and 90 minute (1-3/4" thickness only)
- Optional** Matching wood species, all sides; prefinishing
Custom sizes available
- Warranty** Residential grade - 1 year limited;
Commercial grade - 3 year limited

Unfinished Wood Flush Panels

(Requires Primer, Paint or Stain)

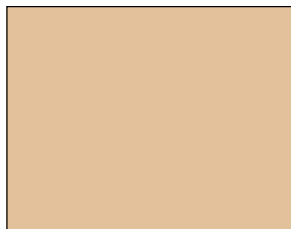

Raw Hardboard

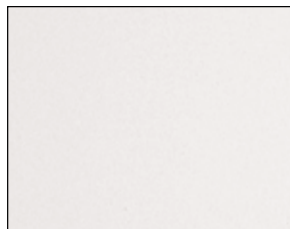

Primed Hardboard

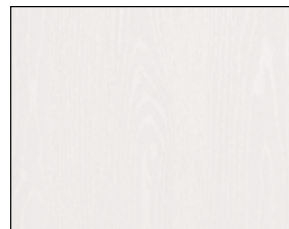

Primed Textured



Natural Birch



Uniform Light Birch



Select White Birch





Painted Primed Hardboard Door and Schlage Orbit Knob with Greyson Rose in Satin Nickel

MASONITE.

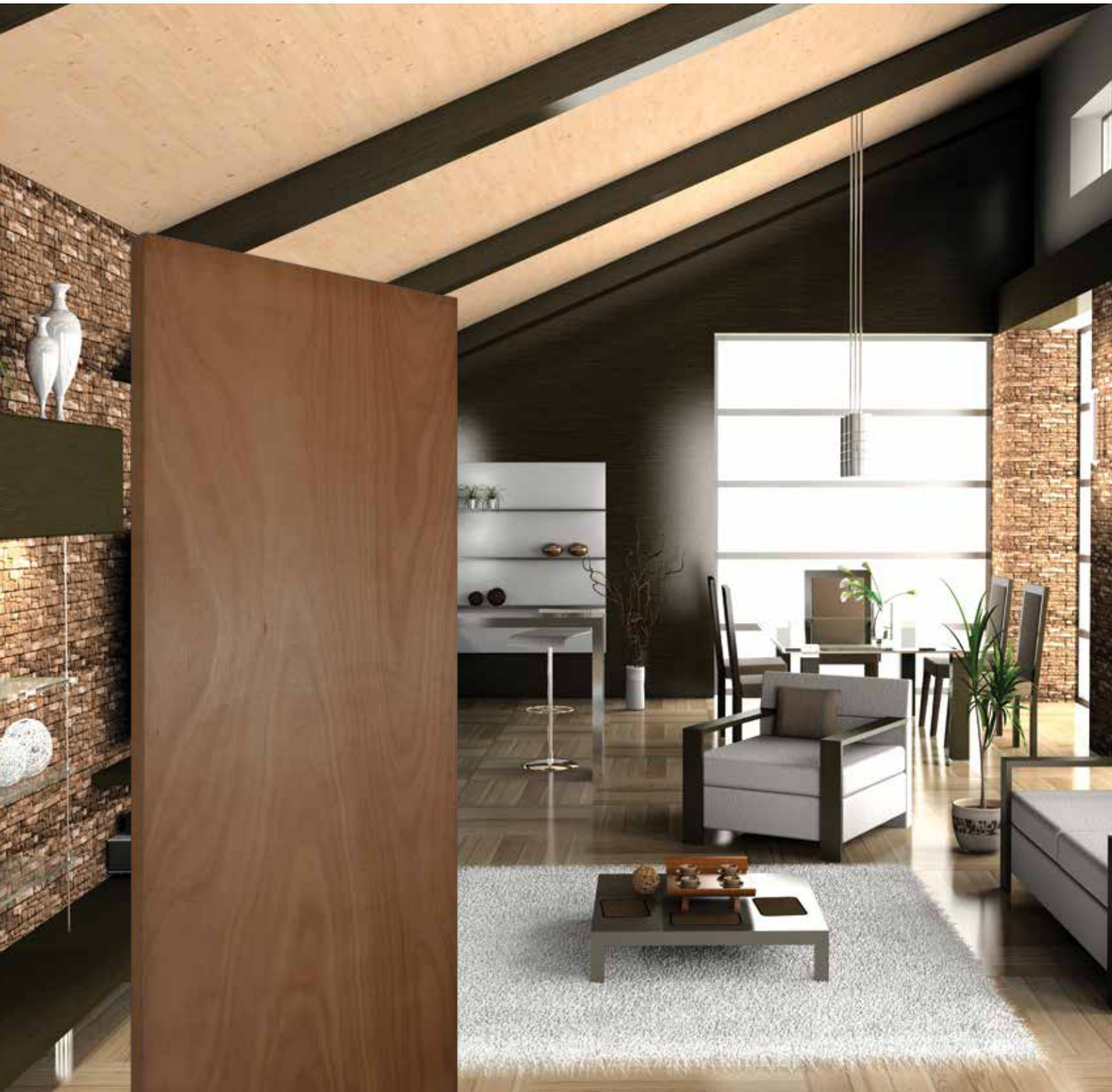

Custom Stain Rotary Mahogany Slab



Unfinished Wood Flush Panels

(Requires Primer, Paint or Stain)



Flat Sliced Red Oak



Rift Cut Red Oak



Rift Cut White Oak



Rotary Mahogany



Flat Sliced White Oak

Factory Prefinished Flush Panels

(No Finishing Required)



Driftwood Oak



Marquis Oak



Strand Oak



Albany Maple



Newport Cherry

STILE & RAIL SERIES

FRENCH DOOR MIX & MATCH PROGRAM



Unfinished Maple I-Lite with Frosted Glass

Primed Engineered Wood I-Lite with Frosted Glass

Step 1: Pick Your Rim

Handcrafted wood or primed engineered wood stile and rail designs can be mixed and matched with contemporary glass textures, creating combinations to complement your interior style.

Wood Veneer or Primed Engineered Rim

- Door** Primed engineered wood or Maple hardwood veneer
- Profile** Raised Panel Ovolo Sticking (A)
- Thickness** 1-3/8"
- Height** 80" (6/8)
- Passage** 24" (2/0), 28" (2/4), 30" (2/6), 32" (2/8), 36" (3/0)
- Warranty** 1 year limited

Sticking Profile

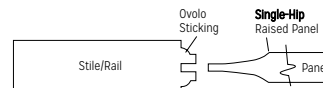

Raised Panel Single Hip (A)

Step 2: Pick Your Glass

Glass Options



White Laminated



Clear Tempered



Narrow Reed 1/8"

Custom order French door options available. For additional selection, see the Interior Doors section at madero.ca.

ONE LITE

Handcrafted wood or primed engineered wood stile and rail designs can be mixed and matched with contemporary glass textures, creating endless combinations to complement your interior style. Consider using the space efficiency of pocket doors for smaller rooms, and bypass or double doors for closet access.



Wood Veneer or Primed Engineered Wood Rim

- Door** Primed engineered wood or hardwood veneer (wood species on page 20)
- Profile** Ovolo Sticking (A) or Shaker Sticking (K) (refer to page 25); custom (upcharge)
- Glass** Refer to pages 29-31
- Thickness** 1-3/8" or 1-3/4"
- Height** 80" (6/8), 84" (7/0), and 96" (8/0)
- Passage** 18" (1/6), 24" (2/0), 28" (2/4), 30" (2/6), 32" (2/8), 34" (2/10), 36" (3/0)
- Warranty** 1 year limited

PANEL LITE

Finding the right style to reflect your tastes is very important. These modern designs are a refreshing update to traditional French doors, highlighting the beauty of your contemporary decor. Their simple elegance allows natural light to cascade from room to room, filling your home with a magic all of its own.

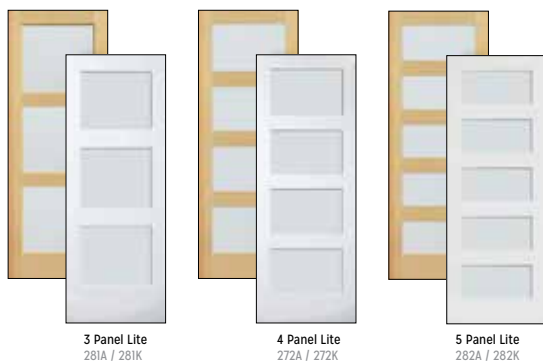

Wood Veneer or Primed Engineered Wood Rim

- Door** Primed engineered wood or hardwood veneer (wood species on page 20)
- Profile** Ovolo Sticking (A) or Shaker Sticking (K) (refer to page 25); custom (upcharge)
- Glass** Refer to pages 29-31
- Thickness** 1-3/8" or 1-3/4"
- Height** 80" (6/8), 84" (7/0), and 96" (8/0)
- Passage** 18" (1/6), 24" (2/0), 28" (2/4), 30" (2/6), 32" (2/8), 34" (2/10), 36" (3/0)
- Warranty** 1 year limited

PRIMED ENGINEERED WOOD

Primed engineered wood doors combine the best of authentic stile and rail craftsmanship with engineered wood technology for more stability than solid wood. Ideal for painted applications, these 18 popular panel designs will give your home a true mark of distinction.



Engineered Wood Slab

- Door** Primed engineered wood with smooth paintable surface
- Profile** Raised Panel (A) or Shaker Panel (K); custom (upcharge)
- Thickness** 1-3/8" or 1-3/4"
- Height** 80" (6/8), 84" (7/0), and 96" (8/0)
- Passage** 18" (1/6), 24" (2/0), 28" (2/4), 30" (2/6), 32" (2/8), 34" (2/10), 36" (3/0)
- Bifold** 24" (2/0), 30" (2/6), 36" (3/0)
- Warranty** 1 year limited

*Primed Engineered Wood
3-Panel Mission*



3 Panel Equal
281A / 281K



4 Panel Equal
272A / 272K

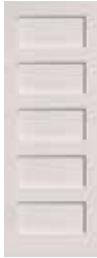

5 Panel Equal
282A / 282K



1 Panel Square
271A / 271K



2 Panel Square
092A / 092K



3 Panel Square
116A / 116K



4 Panel Square
095A / 095K



5 Panel Square
103A / 103K



6 Panel Square
105A / 105K



3 Panel Mission
303A / 303K



2 Panel Arch Top
093A



3 Panel Arch Top
118A



4 Panel Arch Top
097A



5 Panel Arch Top
104A



2 Panel Camber Top
265A / 265K



3 Panel Camber Top
287A / 287K



4 Panel Camber Top
266A / 266K



5 Panel Camber Top
326A / 326K



WOOD PANEL

Handcrafted wood doors transcend the ordinary, commanding attention with timeless beauty at an affordable price. Natural hardwood with wood composite core construction provides excellent thermal efficiency in all seasons. Distinctive raised panels (profile A) or modern shaker panels (profile K) bring refinement to any decor.



Wood Veneer Slab

Door	Natural wood veneer overlay on wood composite core construction
Profile	Raised Panel (A) or Shaker Panel (K); custom (upcharge)
Thickness	1-3/8" or 1-3/4"
Height	80" (6/8), 84" (7/0), and 96" (8/0) <i>(Subject to availability)</i>
Passage	18" (1/6), 24" (2/0), 28" (2/4), 30" (2/6), 32" (2/8), 34" (2/10), 36" (3/0)
Bifold	24" (2/0), 30" (2/6), 36" (3/0)
Warranty	1 year limited

Standard Wood Species



Standard Panel/Sticking Profiles

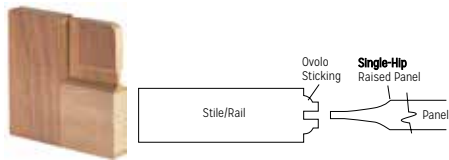

Raised Panel Single Hip (A)
Single Ovolo sticking

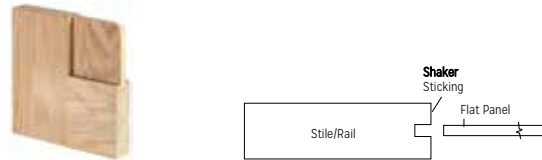

True Shaker Panel (K)
Shaker sticking

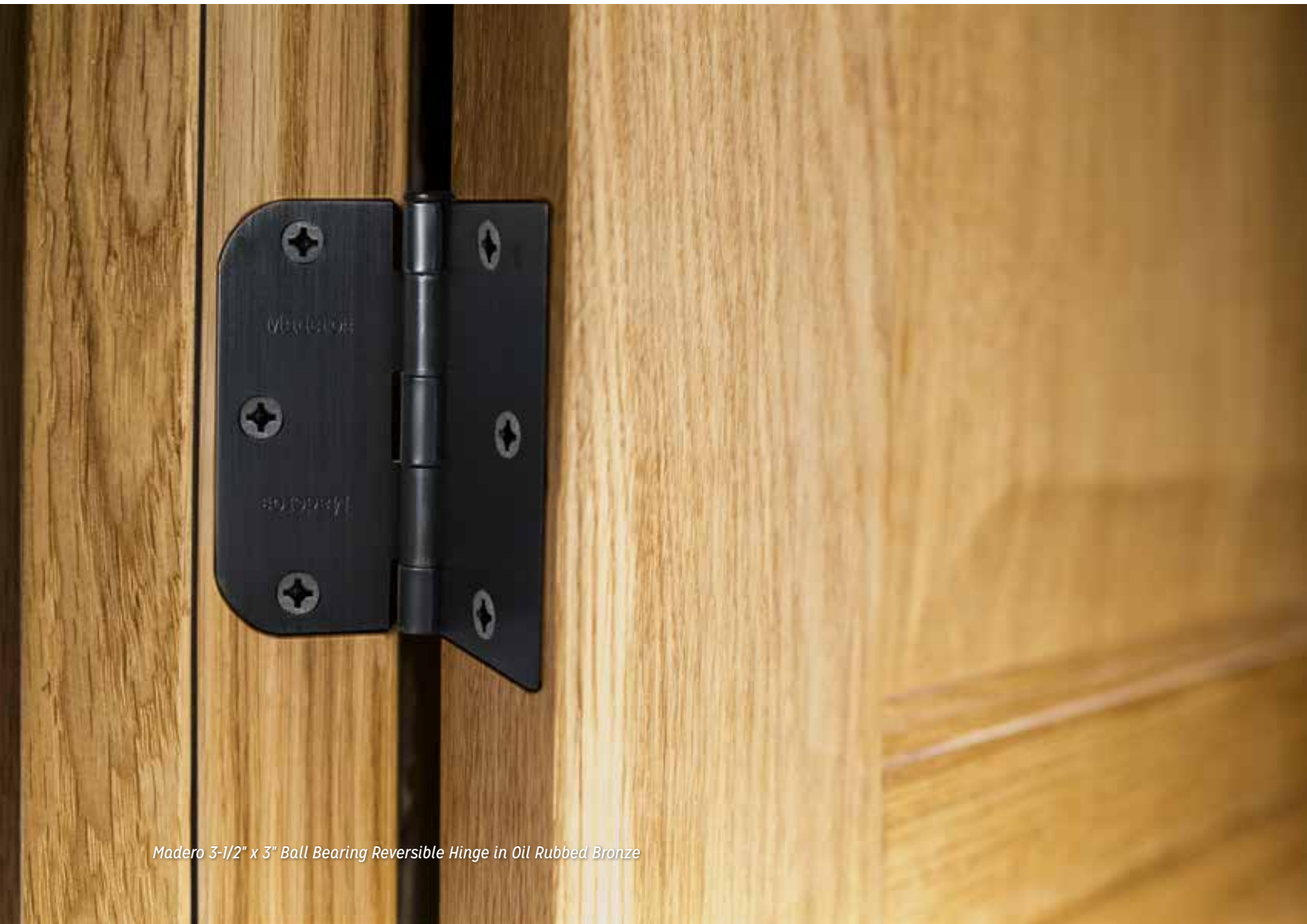

Madero 3-1/2" x 3" Ball Bearing Reversible Hinge in Oil Rubbed Bronze

HINGE OPTIONS

Madero Door Hinges

3-1/2" x 3" ball bearing reversible hinges are typically used for standard 1-3/8" door slab.



Reversible



1/4" Radius

Finishes:

Door hinges look best when matched to your chosen locksets. Choose from our finish options to achieve a custom look.



C-2G
Zinc
Plated



C-4
Brushed
Brass



C-10B
Oil Rubbed
Bronze



C-15
Satin
Nickel



C-15A/
C-17A
Antique Nickel



C-26D
Brushed
Chrome



C-32D
Stainless
Steel



C-1D
Matte
Black



Prehung

WOOD FRAME OPTIONS

Madero Jamb Packs

Choose from primed MDF or matching wood veneer, ready to paint or stain. Madero's jamb packs ship complete with flat jamb or rabbeted jamb, door stop (flat jamb only), machined jamb, and three 3-1/2" ball bearing hinges on handed jamb packs. Reversible jamb packs include plain bearing reversible hinges.

- Bullnose or Colonial stop available
- Jamb packs are available left or right handed, or reversible



BARN TRACK HARDWARE

Solid Flat Bar Hardware Kits



- Hangers** Straight Strap, Top of Door Strap, or Bent Strap
- Application** 1-3/8" wood door; maximum weight 150 lbs per door
- Track** 78-3/4" trimmable flat track; 1-9/16" height
- Opening** Up to 36" wide; multiple tracks required for wider openings
- Finishes** Stainless Steel, Matte Black, Bronze
- Contents** Flat track, 5 wall spacers, 2 hangers, 2 anti-jump discs, high density plastic wheels, floor guides, anchors, bolts/screws
- Options** Joiner kit includes hex key and 4 heavy-duty matching screws, for double door barn track application requiring 2 track lengths
Optional 96" trimmable track available (special order)



Bent Strap



Top of Door Strap



Joiner Kit

SLIDING DOOR HARDWARE

Johnson 2610SC Sliding Track & Hardware



The 2610SC is a versatile and easy to install soft closing wall mounted sliding door hardware set ideally suited where the installation of a Pocket Door is not structurally possible or cost effective, including closets, storage rooms or anywhere space is limited. It is for interior use only and not suited for external applications.

- Size** 48" max width
- Application** Interior, Residential
- Capacity** 1-3/8" or 1-3/4" doors up to 200 lbs (91kg) each
- Finishes** Mill grade aluminum or anodized aluminum



BYPASS DOOR HARDWARE

Johnson 1166 Bypass Track & Hardware



An economical prefinished gold colored steel bypass track with convex track rails, which provide one point contact between wheel and track. One wheel (7/8" dia.) hangers with three point locking. One inch high woodtone adjustable door guide. Brass-tone steel parts.

- Size** 48", 60", 72"
- Application** Interior, Residential
- Capacity** 1-3/8" or 1-3/4" doors up to 50 lbs (23kg) each
- Finishes** Gold coloured steel

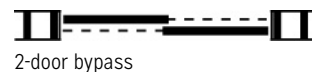

2-door bypass

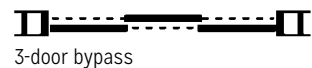

3-door bypass



4-door bypass



Painted Riverside 5-Panel Equal on Acme Barn Track with Bent Strap Hangers in Bronze, and Rockwood SoftMet 16" Offset Pull

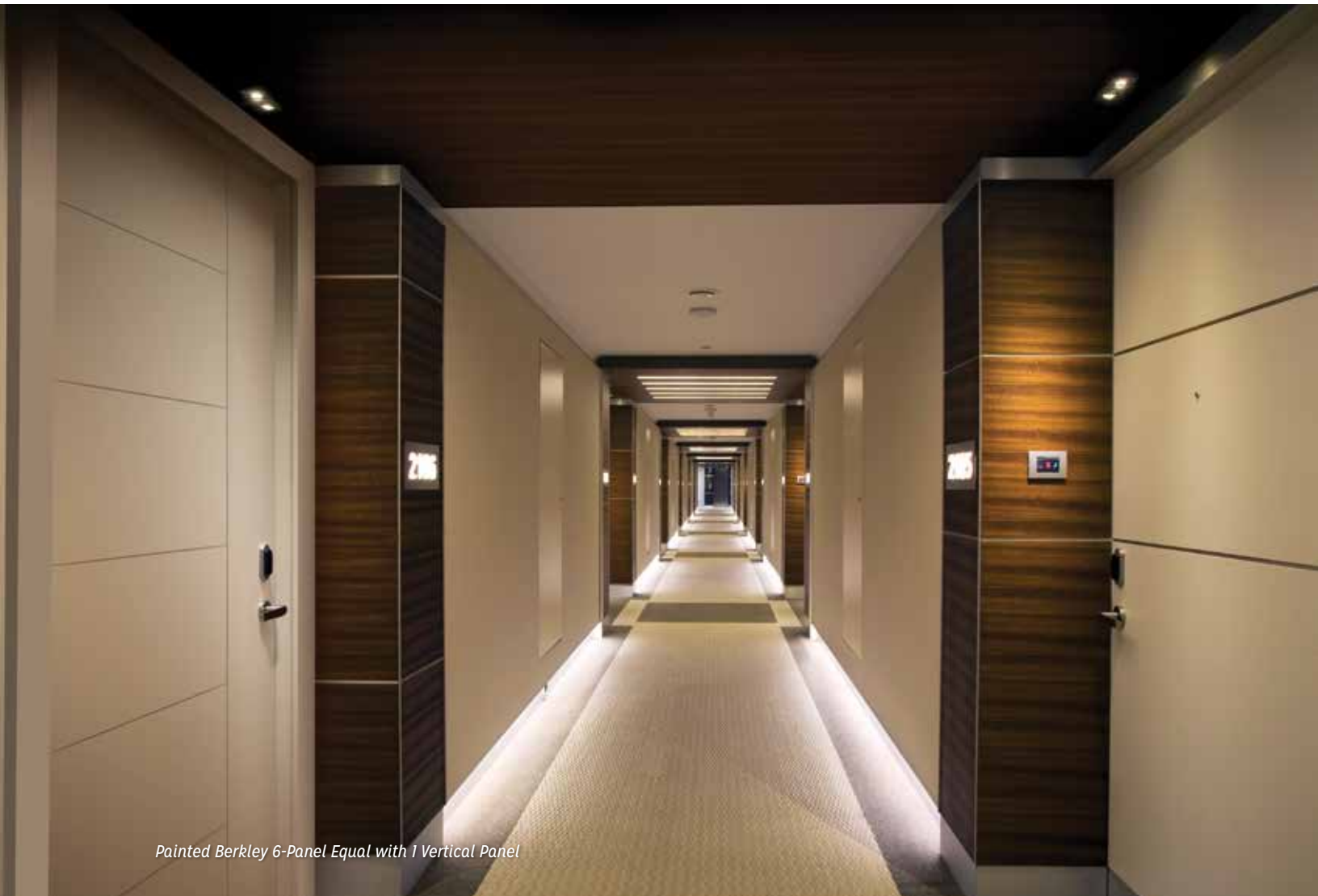

Painted Berkley 6-Panel Equal with 1 Vertical Panel

FIRE RATED FRAME OPTIONS

Madero offers the best in door components for the ultimate finished look. Choose a matching frame to complement your new door, made of primed finger joint pine, smooth white or textured woodgrain composite, or galvanized steel.

When safety standards are a priority, choose fire rated doors and frames. Madero's interior door product line features the standard 20 minute Warnock Hersey fire rating, with optional 45, 60, and 90 minute ratings available. These materials can withstand extreme temperatures and keep what's inside safe.

fire rated
Madero 



Intertek

CHECKLIST FOR CUSTOM INTERIOR DOOR MACHINING

Many details come together to create the perfect interior door package. Follow this important checklist to ensure your order is complete and the end result is exactly as you imagined.

1 Choose Your Door

MOULDED PANEL PROFILE _____ STILE & RAIL PROFILE _____

FLUSH PROFILE _____ FRENCH PROFILE _____

Choose door size:

Width: 1/6 (18") 2/0 (24") 2/4 (28") 2/6 (30") 2/8 (32") 2/10 (34") 3/0 (36")

Other (please specify) _____

Height: 6/8 (80") 7/0 (84") 8/0 (96") Other (please specify) _____

Thickness: 1-3/8" 1-3/4" **Core:** Hollow Solid

2 Choose Your Jamb

MDF FJP Maple Oak Double Rab FJP* Other (please specify) _____

Jamb depth: 4-9/16" (2x4) 6-9/16" (2x6) Other (please specify) _____

Stop: Bullnose (3422) Colonial (936)

* Double Rab FJP jamb only available in 4-9/16"

3 Choose Your Machining Options

Backset: 2-3/8" 2-3/4"

Drilling: 40" 44" Other (please specify) _____

Hinge Quantity: 2 3 4 **Hinge Radius:** 1/4" 5/8" 5/8" SQ/REV

Hinge Finish:

 **C-1D** Matte Black

 **C-10B** Oil Rubbed Bronze

 **C-11P** Antique Bronze

 **C-15** Satin Nickel

 **C-15A** Antique Nickel

 **C-26** Zinc Plated

 **C-26** Bright Chrome

 **C-26D** Satin Chrome

 **C-4** Satin Brass

4 Choose Your Configuration

Single doors:

 Left Hand Inswing Door

 Right Hand Inswing Door

 Left Hand Outswing Door

 Right Hand Outswing Door

Double doors:

 Left Hand Inswing Door

 Right Hand Inswing Door

 Left Hand Outswing Door

 Right Hand Outswing Door

Double Door Options:

Flushbolts: 1 on Top 2 on Top & Bottom

Astragal: Yes No

Lockset Drilling: Active Door

Both Active & Inactive

Dummy Active

Dummy Active & Inactive

Roller Catch: Yes No

Magnetic Catch: Yes No

5 Multiple Doors (House Package)

Qty	Size	Handing

Qty	Size	Handing

Customer Signature: _____ Date: _____

Store Name or #: _____ Tag: _____ PO #: _____



Looking for a high quality, complete door and hardware package for your home? Madero offers a wide array of door designs and configurations with highly customizable glass and hardware options suitable for both interior and exterior applications.



Entry Doors



Designer Entry Doors



Artisan Doors



Multi-Family



Garden Patio Doors



Commercial

Calgary

T 1.800.667.6977 • F 1.403.204.7665

Saskatoon

T 1.800.667.6977 • F 1.306.934.7644

Winnipeg

T 1.800.667.6977 • F 1.204.594.0201

Visit us at:

www.madero.ca

Brochure design by

